



TRAINING FOR ARCHITECTS AND BUILDERS IN THE USE  
OF COMPOSITES FOR THE BUILDING SECTOR

With the support of  Erasmus+  
Programme of the European Union.  
Project number: 2020-1-PL01-KA202-082224



# Instruction for students

**TAB4BUILDING**

TRAINING FOR ARCHITECTS AND BUILDERS IN THE USE OF COMPOSITES FOR THE  
BUILDING SECTOR

Version 1.0

09. 2022

## 1. Course structure

The course is divided into four modules: Materials; Processes; Calculus and Design; Manufacturing. Each module is divided into units that contain activities and resources.

▼ Unit 1.1.

### Composite Materials

▼ Unit 1.2. #

### Material's properties

Following resources are used in Tab4Building Courses

- Book - Multi-page resources with a book-like format.
- File - A picture, a pdf document, a spreadsheet, a sound file, a video file
- Label - Can be a few displayed words or an image used to separate resources and activities in a topic section, or can be a lengthy description or instructions
- Page - The student see a single, scrollable screen that a teacher creates with the robust HTML editor.
- URL - link to any place that can be reached by the web browser.

Following activities are used in Tab4Building Courses

- Forum - allows participants to have asynchronous discussions,
- Quiz - allows the teacher to design and set quiz tests.



To access activity or resource click its description

Access to an activity may be restricted by the obligation to complete another activity or unit.

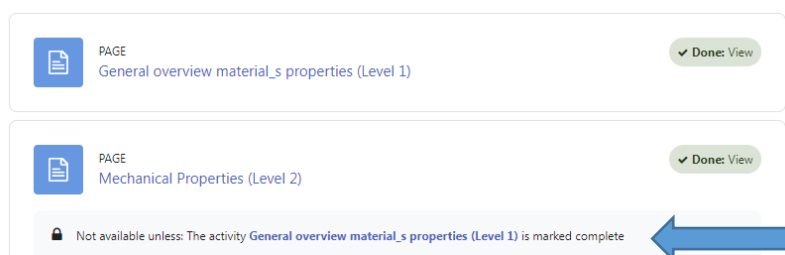

Not available unless: The activity [General overview material\\_s properties \(Level 1\)](#) is marked complete

## 2. How to access the Moodle platform

The platform is managed by the Remote Education Center of the Silesian University of Technology.

The platform is available at <https://platforma.polsl.pl/rb/>

**Only registered users have access to the Platform**

To get a username and password, contact the local administrator of the Tab4Building course. In the feedback, you should receive a login and password for logging in for the first time.

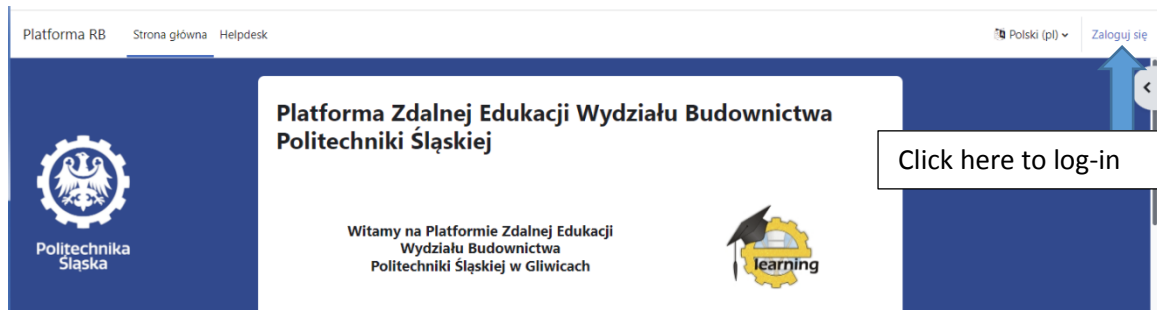

Default login usually contains first name letter+last surname (example John Nowak: *jnowak*)

Initial (default) password: *Erasmus+2020*

Please modify password during the first login. To do it:

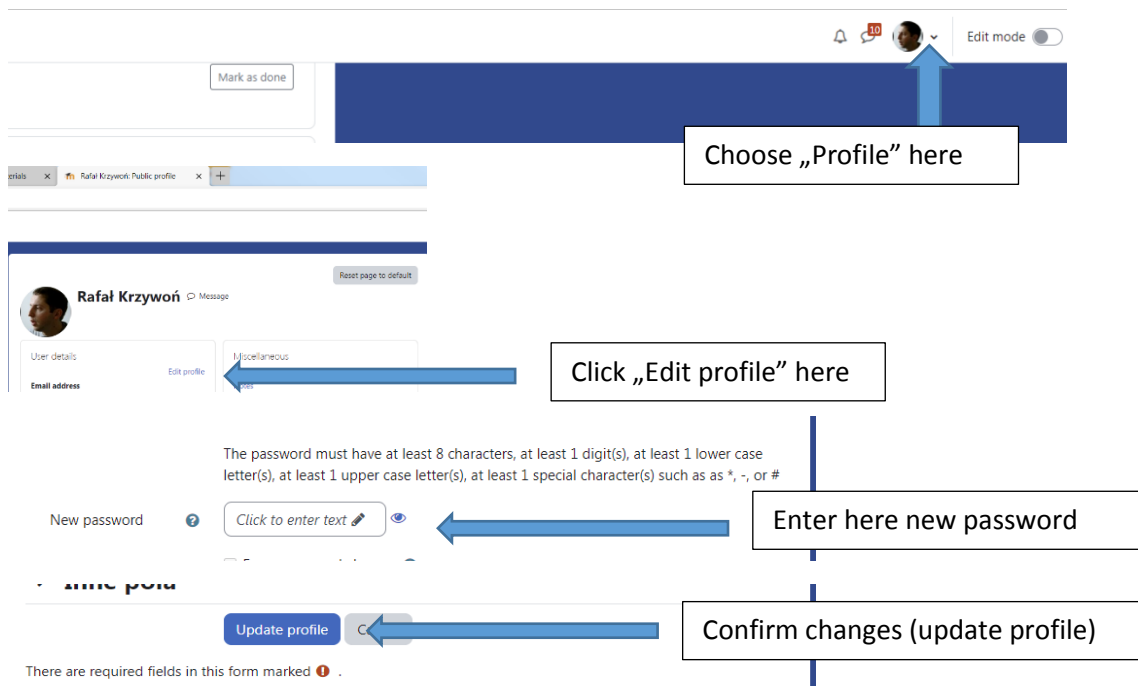

Similarly, other records can be changed, including first name, last name, city of origin, country and others.

Language preferences may be defined here:

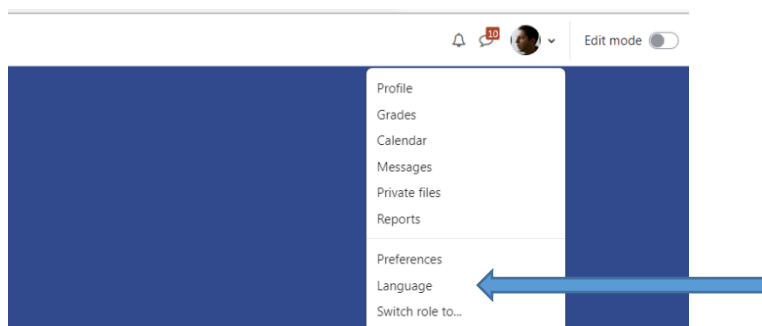

### 3. How to access the course, student enrollment

Courses assigned to a user are available in the top menu.

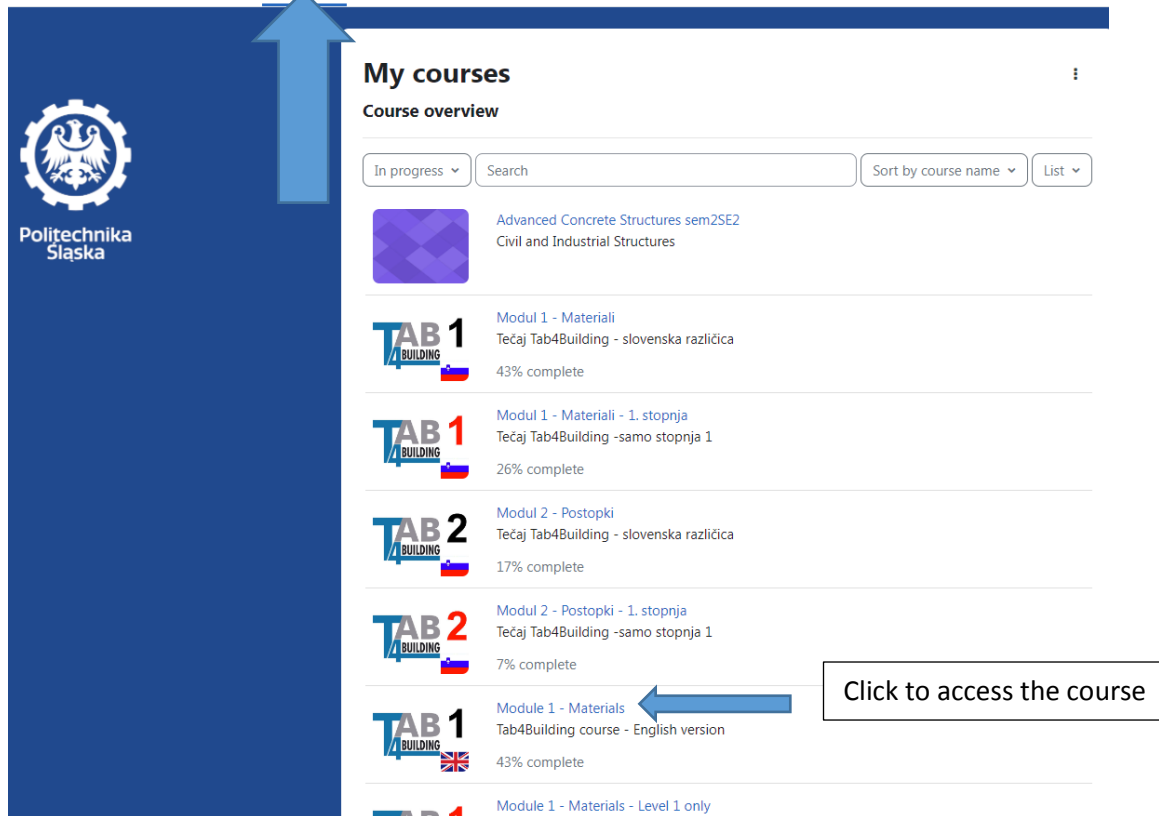

**My courses**

Course overview

In progress Search Sort by course name List

- Advanced Concrete Structures sem2SE2  
Civil and Industrial Structures
- TAB 1** Modul 1 - Materiali  
Tečaj Tab4Building - slovenska različica  
43% complete
- TAB 1** Modul 1 - Materiali - 1. stopnja  
Tečaj Tab4Building -samo stopnja 1  
26% complete
- TAB 2** Modul 2 - Postopki  
Tečaj Tab4Building - slovenska različica  
17% complete
- TAB 2** Modul 2 - Postopki - 1. stopnja  
Tečaj Tab4Building -samo stopnja 1  
7% complete
- TAB 1** Module 1 - Materials  
Tab4Building course - English version  
43% complete
- Module 1 - Materials - Level 1 only

Click to access the course

By default, the student is enrolled by the administrator in the first module of the selected language preference.

A student can gain access to the next module after **completing all the required sources and activities**. By default, access is realized via link. Student Enter the password given in the description under the link.

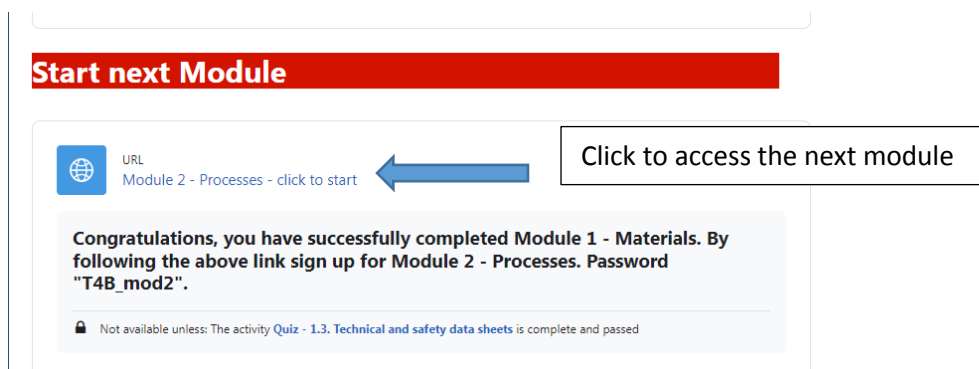

**Start next Module**

URL  
Module 2 - Processes - click to start

Click to access the next module

**Congratulations, you have successfully completed Module 1 - Materials. By following the above link sign up for Module 2 - Processes. Password "T4B\_mod2".**

Not available unless: The activity Quiz - 1.3. Technical and safety data sheets is complete and passed

In case of problems the teacher can also manually enroll the student in a new course. In this case contact the local administrator of the Tab4Building course.

## 4. Completing the Course

The order of completing the course is arbitrary except for sources and activities to which access is limited. Student can select activities using the side menu (Course index) or by pointing to them directly in the course window.

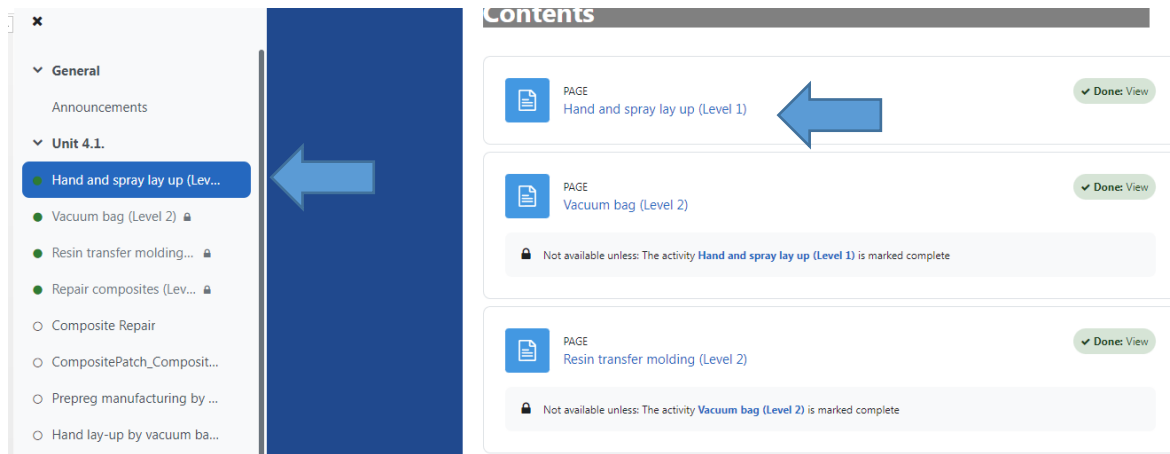

The Module content is presented in the form of a page or book type source. Access to the content is subject to restrictions.

To complete a page the student should access the page and review the content (usually a presentation of several slides).



To compile a book, a student should review the contents of each of its pages. Move between pages by selecting the "next/previous" button).



## 2. Graco's FRP (Fiber-Reinforced Plastic) Chopper & Gel Coating Equipment

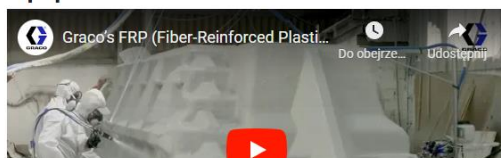

Access to websites, videos, and documents is not subject to restrictions and obligation to complete.

Each quiz must be passed. To access the quiz click its description and in the quiz menu choose "Attempt quiz"

Erasmus+ / 7 / 4 / 2022 / Manufacturing

**Quiz - 4.1. Manufacturing**

Quiz [Question bank](#)

To do: Make attempts: 1    To do: Receive a grade    To do: Receive a passing grade

**Attempt quiz**

Grading method: Highest grade

Grade to pass: 6.00 out of 6.00

The student solves the quiz by choosing the correct answers or answering short questions.

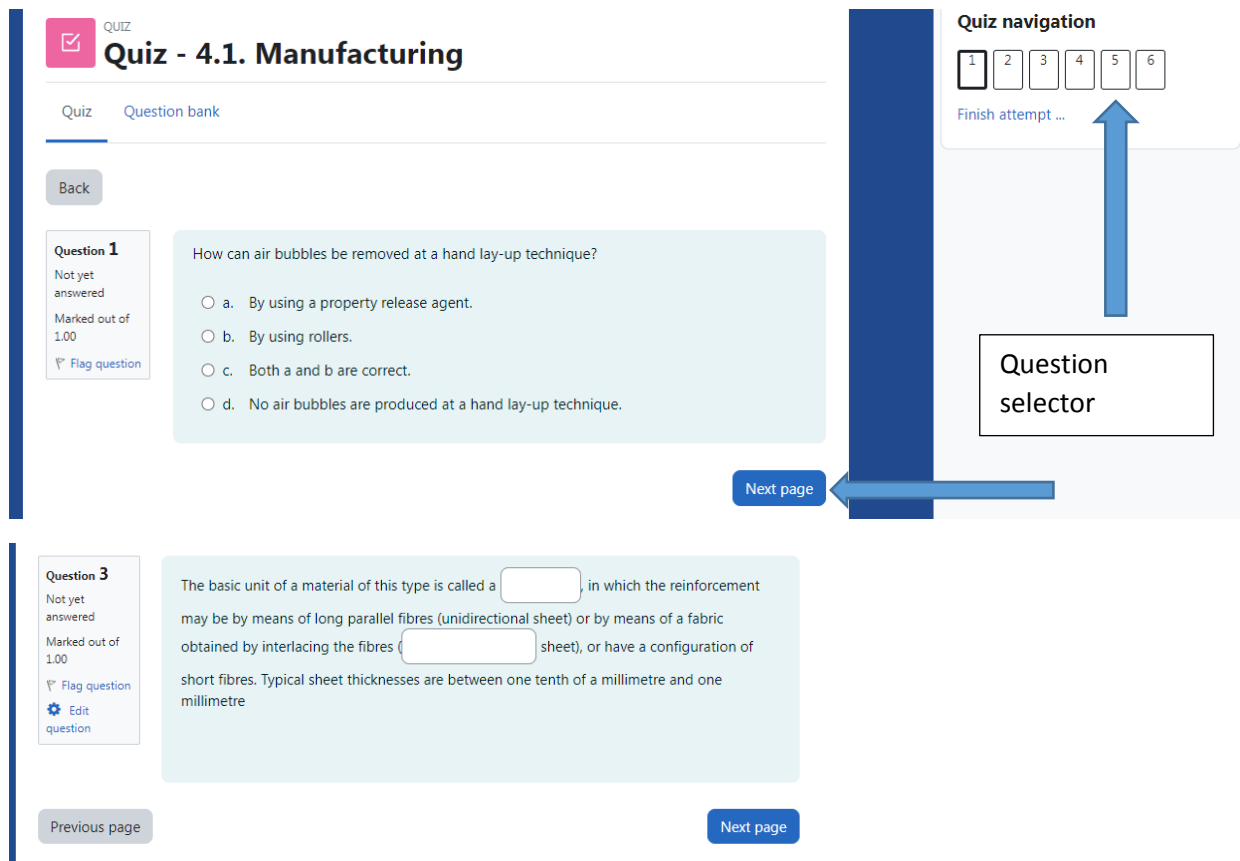

**Quiz - 4.1. Manufacturing**  
 Quiz [Question bank](#)

Back

**Question 1**  
 Not yet answered  
 Marked out of 1.00  
[Flag question](#)

How can air bubbles be removed at a hand lay-up technique?

- a. By using a property release agent.
- b. By using rollers.
- c. Both a and b are correct.
- d. No air bubbles are produced at a hand lay-up technique.

Next page

**Question 3**  
 Not yet answered  
 Marked out of 1.00  
[Flag question](#)  
[Edit question](#)

The basic unit of a material of this type is called a  in which the reinforcement may be by means of long parallel fibres (unidirectional sheet) or by means of a fabric obtained by interlacing the fibres ( sheet), or have a configuration of short fibres. Typical sheet thicknesses are between one tenth of a millimetre and one millimetre

Previous page    Next page

**Quiz navigation**  
 1 2 3 4 5 6  
 Finish attempt ...

Question selector

After solving the quiz, the student should confirm its completion.

## Quiz - 3.1 Introduction Calculus and Design

### Summary of attempt

Question	Status
1	Answer saved
2	Answer saved
3	Answer saved
4	Answer saved

Return to attempt

Submit all and finish

The report displayed for the completed course allows the student to check the correct answers.

**Question 1**  
Incorrect  
Mark 0.00 out of 1.00  
[Flag question](#)

1. When you apply a reinforcement of a structure made by composites, you need to protect it for

- a. Corrosion ✖
- b. Chemical attack
- c. Fire protection
- d. All of them

Your answer is incorrect.

## 5. Certificate of Course Completion.

After completing the Module 4 "Manufacturing" the student obtains a "Certificate of Course Completion". It can be printed with Course Specification.

**Print Certificate of Completion**

 CUSTOM CERTIFICATE  
Certificate of Course Completion

Not available unless: The activity Quiz - 4.3. Circular economy is marked complete

Click to download the Certificate

 FILE  
Specification of Level 1

Not available unless: The activity Quiz - 4.3. Circular economy is marked complete

Click to download the Course Specification

 FILE  
Specification of Level 2

Not available unless: The activity Quiz - 4.3. Circular economy is marked complete

[Mark as done](#)